



JANUARY 13, 2016

SCHOOL BUILDING PROJECT COMMUNITY FORUM #4

JCJARCHITECTURE

TODAY'S AGENDA

- Welcome and Introductions
- Organization / Project Team
- Process / Schedule
- **Community Discussion**
- Community Forum #3 Themes
- Design Options
- Preliminary Project Budgets
- **Community Discussion**
- Next Steps



CROCKER FARM



FORT RIVER



WILDWOOD

ORGANIZATION / PROJECT TEAM

SCHOOL BUILDING PROJECT
COMMUNITY FORUM # 4

SCHOOL BUILDING PROJECT
AMHERST, MASSACHUSETTS

JCJARCHITECTURE
JANUARY 13, 2016

ORGANIZATION / PROJECT TEAM

Massachusetts School Building Authority

Wildwood School Building Committee

Owner's Project Manager: Joslin, Lesser + Associates, Inc.

Jeffery Luxenburg, AICP, MCPPO - Project Executive

Thomas P. Murphy, RA, LEED AP, MCPPO - Project Manager

Designer: JCJ Architecture

James E. LaPosta, Jr., FAIA, LEED AP - Principal-in-Charge + Design Principal

Douglas K. Roberts, AIA, LEED AP - Project Manager

James W. Hoagland, AIA, LEED AP - Project Architect

Emily E. Czarnecki, NCIDQ, LEED AP - Interior Designer

Designer: Consultant Team

Educational Programming - New Vista Designs for Learning

Geotechnical Engineering - Lahlaf Geotechnical Consulting, Inc.

Environment / Hazardous Materials - Universal Environmental Consultants

Site, Civil, MEP/FP and Technology - Garcia Galuska & Desousa

Landscape Architecture - Copley Wolff Design Group

Structural - Engineers Design Group

Acoustics - Acentech, Inc.

Food Service - Crabtree & McGrath

LEED/Sustainability - VvS Architects & Consultants

Traffic - Bryant Associates

Massachusetts School Building Authority:

State agency with the mission to partner with local communities to support the design and construction of public school facilities that are:

- Educationally- appropriate
- Flexible / Sustainable
- Cost effective.
- MSBA to fund up to 68% of eligible costs.

Wildwood School Building Committee:

Local committee recognized by the MSBA to oversee the design and construction of public school facilities.

Joslin, Lesser + Associates, Inc.:

Owner's Project Manager responsible for managing the project from design through construction.

JCJ Architecture:

Jim LaPosta : Principal-in-Charge + Design Principal

Responsible for direction of the entire process

- Practice Director/Education Practice Group
- Design Principal for numerous award-winning projects
- Member of AIA's national advisory board: Committee on Architecture in Education

Doug Roberts : Project Manager

Day-to-day point of contact

- Thorough knowledge of project process

David Stephen: Educational Programming

New Vista Designs for Learning, consultant to JCJ, will lead the development of the educational program for the new school building project.

WILDWOOD SCHOOL BUILDING COMMITTEE

- Michael Morris, Assistant Superintendent of Schools, ARPS - Chair
- Katherine Appy, Amherst School Committee, Chair
- Anna Bartolini, Teacher, Crocker Farm Elementary School
- Ron Bohonowicz, Director of Facilities, ARPS & Town of Amherst
- Holly Bowser, MCPPO, Assistant Comptroller, Town of Amherst
- Sasha Figueroa, Administrative Assistant / Recorder, ARPS
- Maria Geryk, Superintendent of Schools, ARPS
- Monica Hall, Director of Diversity & Professional Development, ARPS
- Laura Kent, Wildwood and Preschool Parent
- Sean Mangano, Director of Finance, Amherst Public Schools
- Guilford Mooring, MCPPO, Director of Public Works, Town of Amherst
- Sandy Pooler, Director of Finance, Town of Amherst
- Ludmilla Pavlova, Community Member and former Wildwood parent
- Irv Rhodes, Community Member
- Narayan Sampath, Crocker Farm Parent
- Timothy Sheehan, Teacher, Fort River Elementary School
- Nancy Stewart, Fort River Parent
- Sherril Willis, Teacher, Wildwood Elementary School
- Nick Yaffe, Principal, Wildwood Elementary School
- David Ziomek, Interim Town Manager



CROCKER FARM



FORT RIVER



WILDWOOD

PROCESS / SCHEDULE

SCHOOL BUILDING PROJECT
COMMUNITY FORUM # 4

SCHOOL BUILDING PROJECT
AMHERST, MASSACHUSETTS

JCJARCHITECTURE
JANUARY 13, 2016

PROCESS OVERVIEW

MSBA Building Process

Steps primarily for:

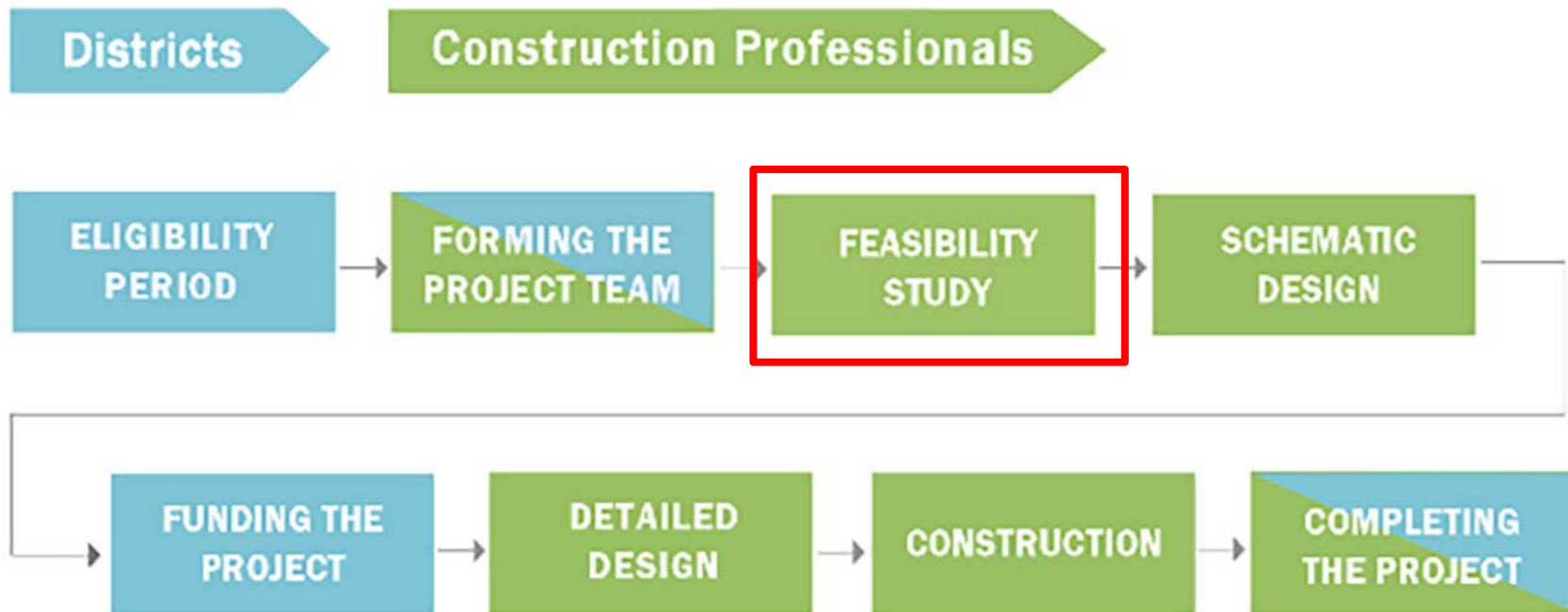

PROCESS OVERVIEW

- ✓ MSBA Statement of Interest (SOI) submitted March 19, 2013
- ✓ MSBA invites SOI into Eligibility Period November 20, 2013
- ✓ Town Meeting approves Feasibility Study funding May 17, 2014
- ✓ MSBA approves Owner's Project Manager April 10, 2015
- ✓ Wildwood School Building Committee formed May 15, 2015
- ✓ MSBA Designer Selection Panel approves Designer July 7, 2015
- ✓ Wildwood School Building Committee hires Designer July 22, 2015
- ✓ MSBA Preliminary Design Program to be submitted December 7, 2015
- **MSBA Preferred Schematic Report to be submitted February 2016**
- MSBA Approves PSR in March 2016
- MSBA Authorizes Project Scope and Budget Agreement Sept 2016
- Town Meeting Votes on Project Scope and Budget Fall 2016
- Debt Exclusion Vote Fall 2016
- MSBA Authorizes Project Funding Agreement December 2016
- Complete Design and Construction on or about August 2019

SCHEDULE

- ✓ Community Forum #1, Tuesday, September 29, 2015
- ✓ School Building Committee Meeting, Tuesday, October 15, 2015
- ✓ School Committee Meeting, Tuesday, October 20, 2015
- ✓ Community Forum #2, Monday, October 26, 2015
- ✓ School Committee Meeting, Tuesday, November 17, 2015
- ✓ School Building Committee Meeting, Thursday, December 3, 2015
 - Authorize PDP submission to MSBA
- ✓ PDP Submission to MSBA, Monday, December 7, 2015
- ✓ Community Forum #3, Tuesday, December 8, 2015
 - Space Template / Site Alternatives / Existing Conditions Update
- ✓ School Committee and School Building Committee Meeting
Tuesday, December 22, 2015
 - Review Preliminary Design Alternatives
- ✓ Select Board Meeting, Monday, January 11, 2016
 - Project Update
- ✓ School Building Committee / School Committee Meeting, January 13, 2016
- ✓ **Community Forum #4, January 13, 2016**
- School Committee Meeting, Tuesday, January 19, 2016
 - Approve Grade Configuration
- School Building Committee Meeting, Thursday, January 21, 2016
 - Approve Preferred Schematic Design Option
- PSR Submission to MSBA, Thursday, February 11, 2016
- MSBA Board Approval, Wednesday, March 30, 2016



AMHERST ELEMENTARY BUILDING PROJECT SCHEDULE

| | | |
|---|--|--|
| January 4, 2016 – January 10, 2016 | Family & Staff Survey | N/A |
| | Survey will be open between these dates; results will be available on January 13, 2016 | |
| January 11, 2016 [7:25-7:50 PM] | Amherst Select Board Meeting | Town Hall |
| | Project Update | |
| January 13, 2016 [4:00-5:30 PM] | Joint Amherst Building & School Committee Meeting | Amherst Regional High School Library |
| | Preliminary Budgets - Design Options - Schedule Review - Survey Results | |
| January 13, 2016 [6:30-8:30 PM] | Community Forum #4 | Amherst Regional High School Library |
| | Preliminary Budgets - Design Options - Schedule Review - Survey Results | |
| January 14, 2016 [3:30-5:00 PM] | Amherst School Committee Meeting | Amherst Regional High School Library |
| | Discuss information regarding Building Project prior to the January 19, 2016 vote | |
| January 19, 2016 [6:00-8:00 PM] | Amherst School Committee Meeting | Amherst Regional High School Library |
| | Vote on Grade Configuration | |
| January 21, 2016 [4:00-6:00 PM] | School Building Committee Meeting | Amherst Regional Middle School Library |
| | Discuss Preferred Schematic Report Design submission | |



AMHERST ELEMENTARY BUILDING PROJECT SCHEDULE

| | | |
|---------------------------------|--|-----|
| February 2, 2016 [4:00-5:30 PM] | School Building Committee Meeting | TBD |
| | Vote on Preferred Schematic Report Design submission | |
| February 11, 2016 | Preferred Schematic Report Design Submission to MSBA | N/A |
| March 30, 2016 | MSBA Board Approval of Preferred Schematic Report Design | TBD |
| September, 2016 | MSBA Board Approval of Project Scope & Budget | TBD |
| October, 2016 | Amherst Town Meeting Approval Vote | TBD |
| November 8, 2016 | Anticipated Override Vote | TBD |



CROCKER FARM



FORT RIVER



WILDWOOD

PROCESS / SCHEDULE QUESTIONS

SCHOOL BUILDING PROJECT
COMMUNITY FORUM # 4



CROCKER FARM



FORT RIVER



WILDWOOD

COMMUNITY FORUM #3 THEMES

SCHOOL BUILDING PROJECT
COMMUNITY FORUM # 4

COMMUNITY FORUM #3 THEMES

- Awesome opportunity to build a new school for two school communities ... this should be a positive conversation.
- This is a 50 year decision ... it should consider all kids ... this is the right thing to do at the right time ... the decision should address both schools.
- Use MSBA funding for WES and Town funding for FRES in lieu of other future Town capital projects.
- This school should look like something that is welcoming for little kids but cool enough for older kids ... it should appeal to the kids.
- Seek LEED Gold certification ... set an example for the students.
- Primary goal should be based on educational research that indicates small schools matter ... students build relationships over time ... research shows that bigger schools effect disadvantaged students more.
- Marks Meadow community dissolved over 5 years ago, absorbed into the remaining schools ... regardless of the option, school communities will remain vibrant.
- Wider on-line community and teacher surveys are recommended to provide School Committee feedback prior to grade configuration vote.

❖ *School Committee completed two on-line surveys; results to be discussed at January 14th, 2016 meeting at 3:00PM in ARHS Library.*

Visit <http://wildwood.projects.joslinlessner.com> to review all of the **Community Forum #3** comments.



CROCKER FARM



FORT RIVER



WILDWOOD

DESIGN OPTIONS & BUDGETS

SCHOOL BUILDING PROJECT
COMMUNITY FORUM # 4

MSBA GRADE CONFIGURATION OPTIONS

1. **THREE DISTRICT K-6 ELEMENTARY SCHOOLS**

- Crocker Farm – Existing to remain.
- Fort River – Existing to remain.
- Wildwood – Renovation or new construction for 360 students.

2. **TWO DISTRICT K-6 ELEMENTARY SCHOOLS**

- Crocker Farm - Existing to remain.
- Fort River - New construction for 670 students or closed.
- Wildwood – Renovation or new construction for 670 students or closed.

3. **DISTRICT 2-6 ELEMENTARY SCHOOL**

- Crocker Farm – Becomes Pre-K-1 Early Childhood Center.
- Fort River - New construction for 750 students or closed.
- Wildwood – Renovation or new construction for 750 students or closed.

DESIGN OPTIONS – 360 STUDENTS

GRADES K-6

- Existing Wildwood Code Updates
- Option W1 –Renovation of Existing Wildwood
- Option W2 - New Construction on Wildwood Site

WILDWOOD - CODE UPDATE OPTION



WILDWOOD - CODE UPDATE OPTION

LEGEND

- GENERAL CLASSROOMS
- SPECIALIZED CLASSROOMS
- CORE SPACES
- ADMINISTRATIVE / FACULTY
- BUILDING SUPPORT SPACES
- CIRCULATION/STAIRS/ELEVATORS



OPTION W1 -RENO (360 K-6)



OPTION W1 - RENO (360 K-6)



OPTION W2 -NEW (360 K-6)

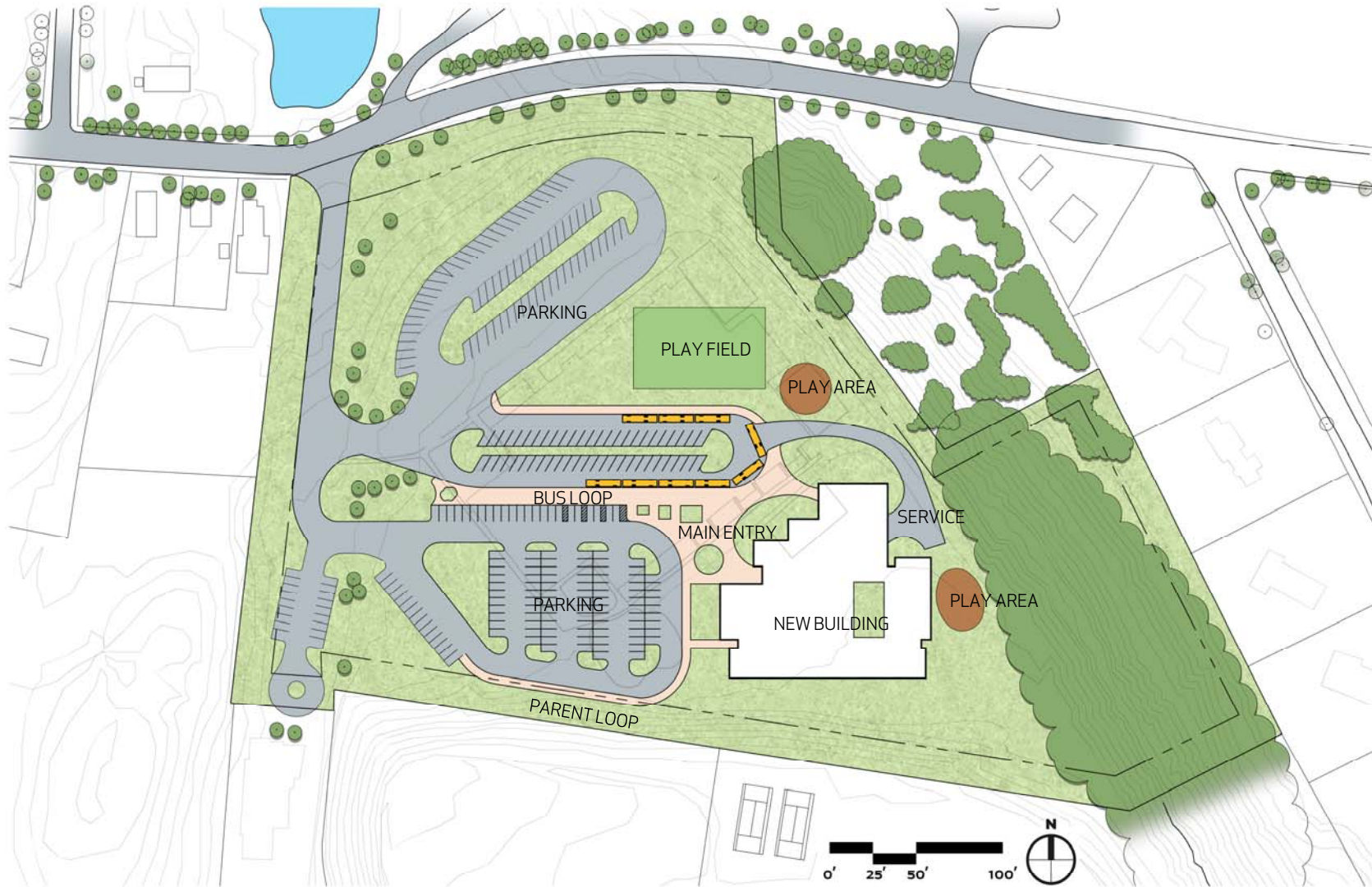

OPTION W2 – FIRST FLOOR PLAN (360 K-6)

OPTION W2 - 360 STUDENTS - GRADES K-6

TOTAL SF - 68,080sf
 FOOTPRINT SF - 42,392sf
 PARKING SPACES (REQ'D) -
 PARKING SPACES (PROVD) -
 PLAY FIELD
 PLAY AREAS

PROGRAM HIGHLIGHTS:

3 KINDERGARTENS (1100sf)
 16 CLASSROOMS (950sf)
 3 SPED CRs (950sf)
 4 RESOURCE RMs (260sf)
 2 ELL RMs (600sf)
 2 SPEECH RMs (150sf)
 1 ART RMs (1000sf)
 1 MUSIC RMs (1200sf)
 1 GYM (6000sf)
 1 CAFETERIA (2400sf)
 1 LIBRARY (2600sf)

LEGEND

- GENERAL CLASSROOMS
- SPECIALIZED CLASSROOMS
- CORE SPACES
- ADMINISTRATIVE / FACULTY
- BUILDING SUPPORT SPACES
- CIRCULATION/STAIRS/ELEVATORS

0 10 20 40 60



OPTION W2 – SECOND FLOOR PLAN (360 K-6)

OPTION W2 - 360 STUDENTS - GRADES K-6

TOTAL SF - 68,080sf
 FOOTPRINT SF - 42,392sf
 PARKING SPACES (REQ'D) -
 PARKING SPACES (PROVD) -
 PLAY FIELD
 PLAY AREAS

PROGRAM HIGHLIGHTS:

3 KINDERGARTENS (1100sf)
 15 CLASSROOMS (950sf)
 3 SPED CRs (950sf)
 4 RESOURCE RMs (250sf)
 2 ELL RMs (500sf)
 2 SPEECH RMs (150sf)
 1 ART RMs (1000sf)
 1 MUSIC RMs (1200sf)
 1 GYM (6000sf)
 1 CAFETERIA (2400sf)
 1 LIBRARY (2600sf)

LEGEND

- GENERAL CLASSROOMS
- SPECIALIZED CLASSROOMS
- BUILDING SUPPORT SPACES
- CIRCULATION/STAIRS/ELEVATORS

0 10 20 40 60



PLAN
NORTH



DESIGN OPTIONS – 750 STUDENTS

GRADE RECONFIGURATION 2-6

- Option W10 - Renovation + Additions at Wildwood Site
- Option W7 –New Construction at Wildwood Site
- Option FR5 –New Construction atFort River Site

OPTION W10 - ADD/RENO (750 2-6)

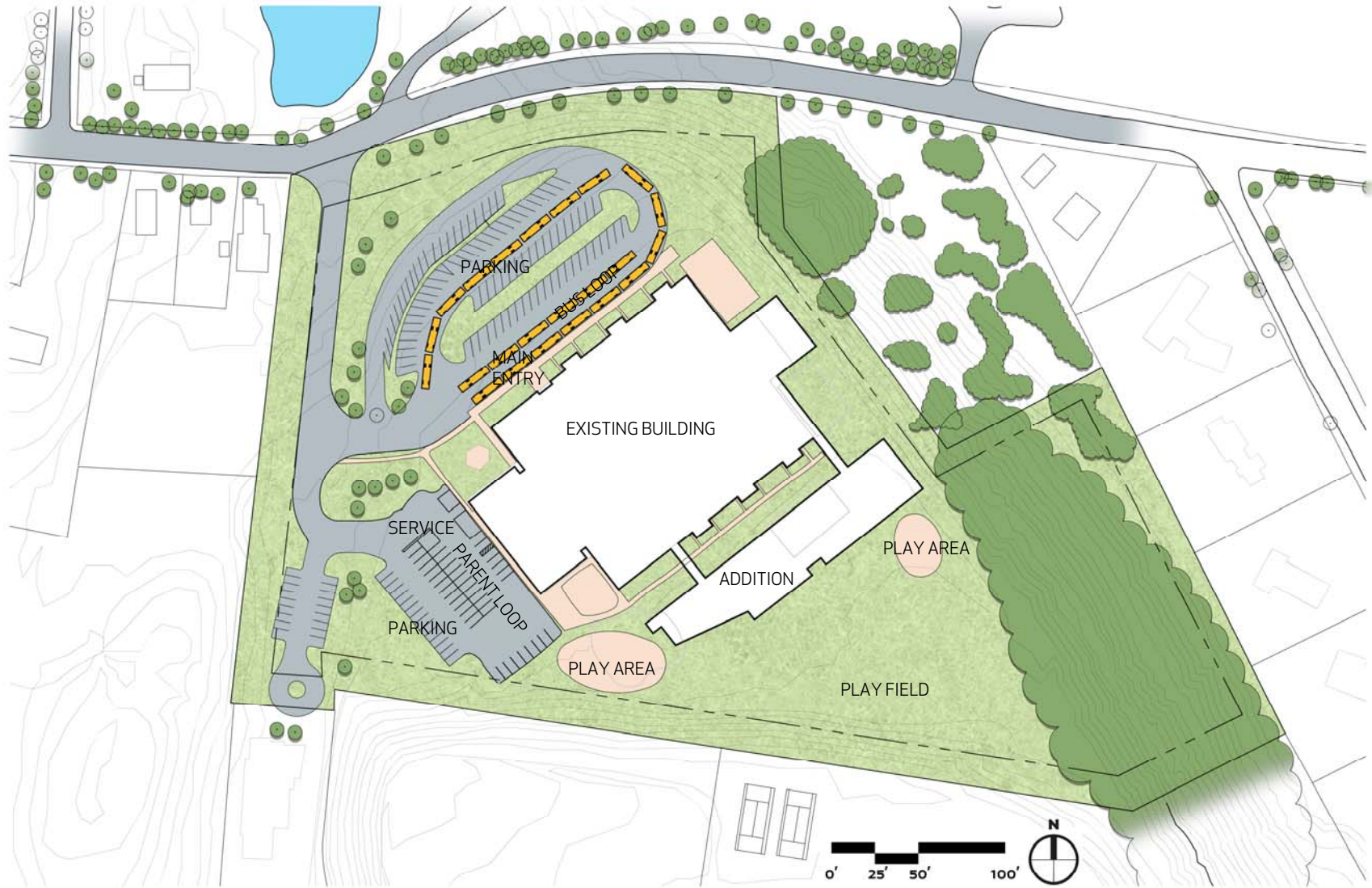

OPTION W10 - FIRST FLOOR PLAN (750 2-6)



OPTION W10 – SECOND FLOOR PLAN (750 2-6)

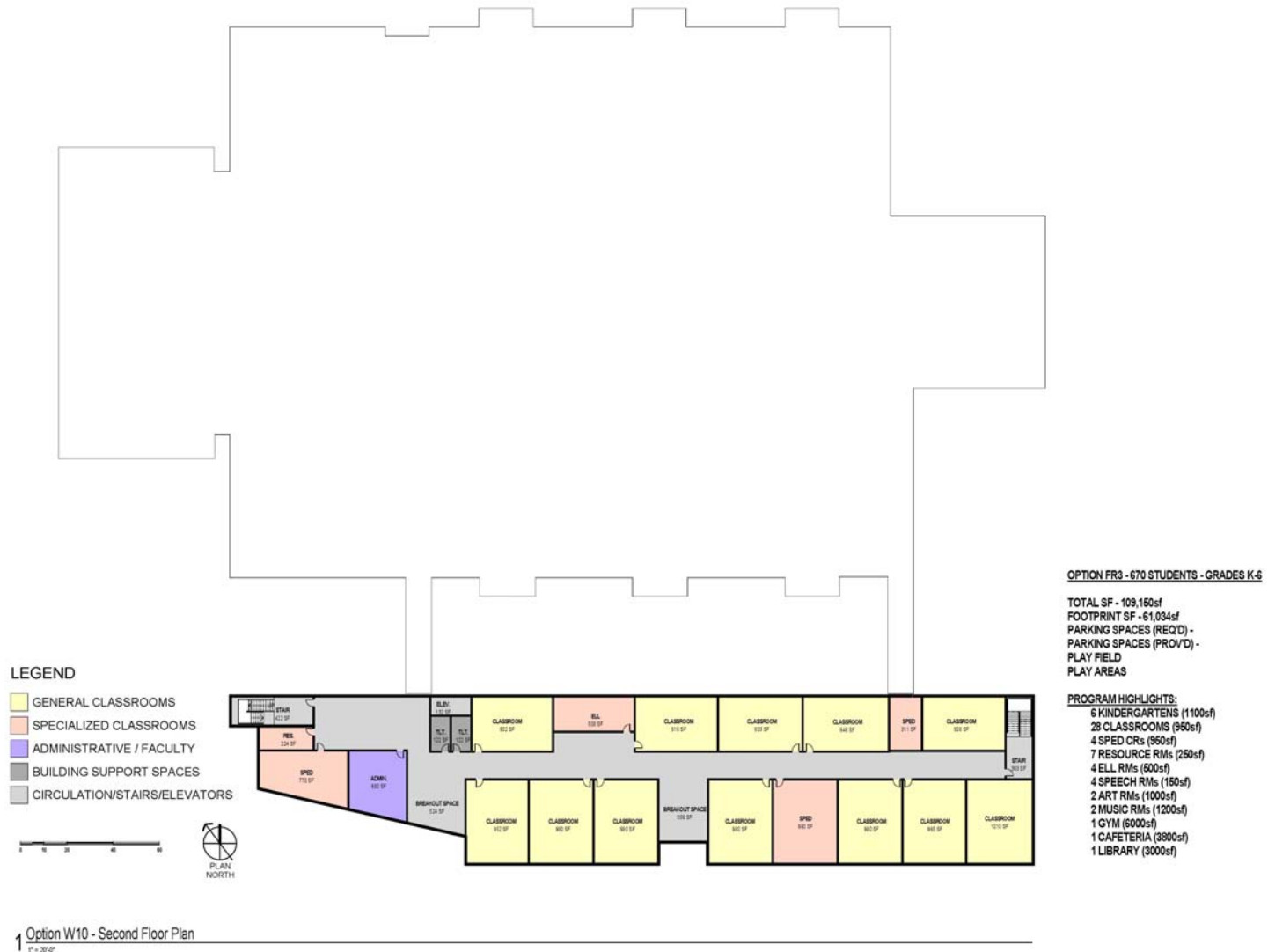

OPTION W7 - NEW (750 2-6)

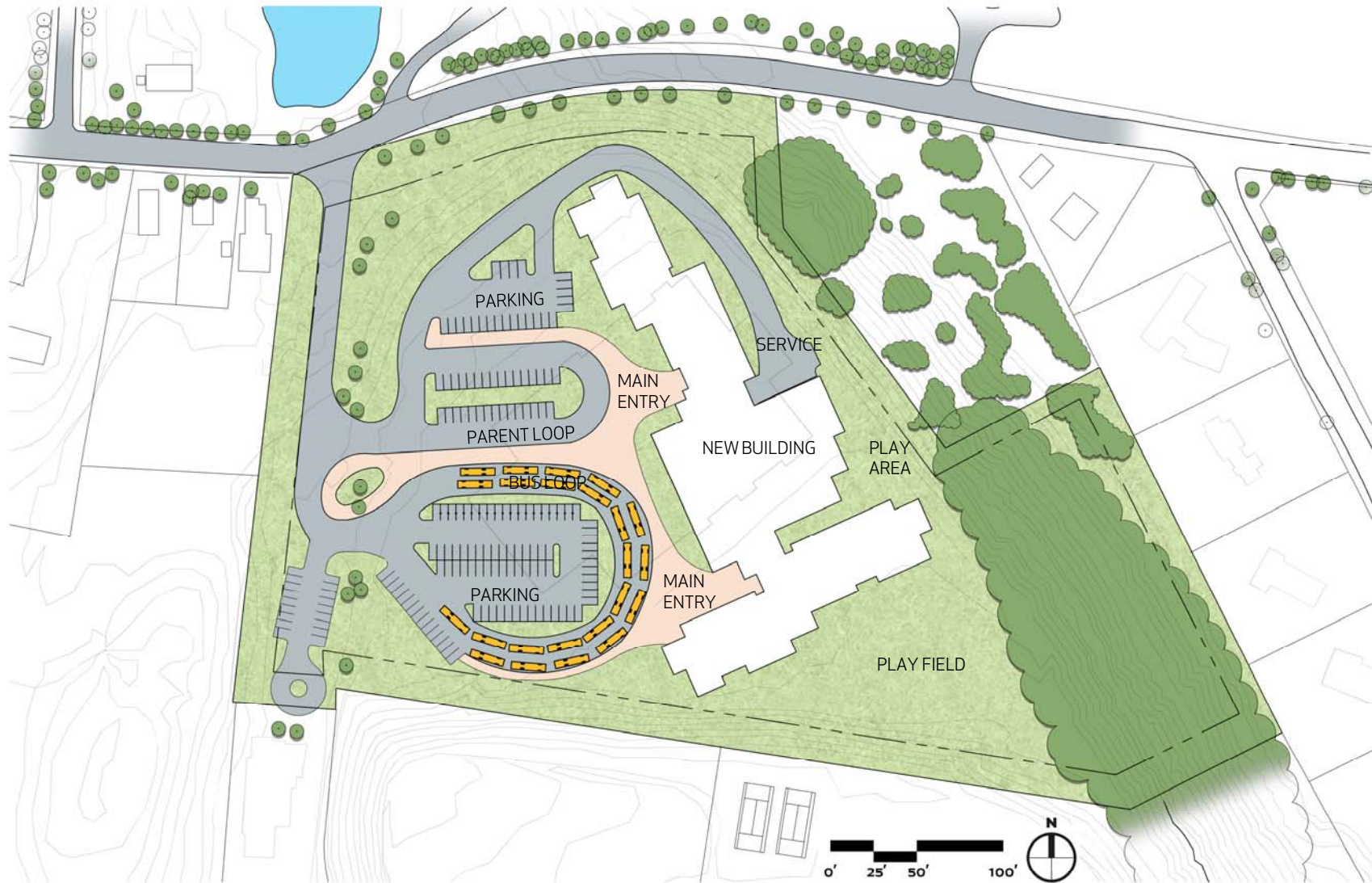

OPTION W7 - FIRST FLOOR PLAN (750 2-6)



1 OPTION W7 - FIRST FLOOR PLAN
 1" = 20'

OPTION W7 - SECOND FLOOR PLAN (750 2-6)

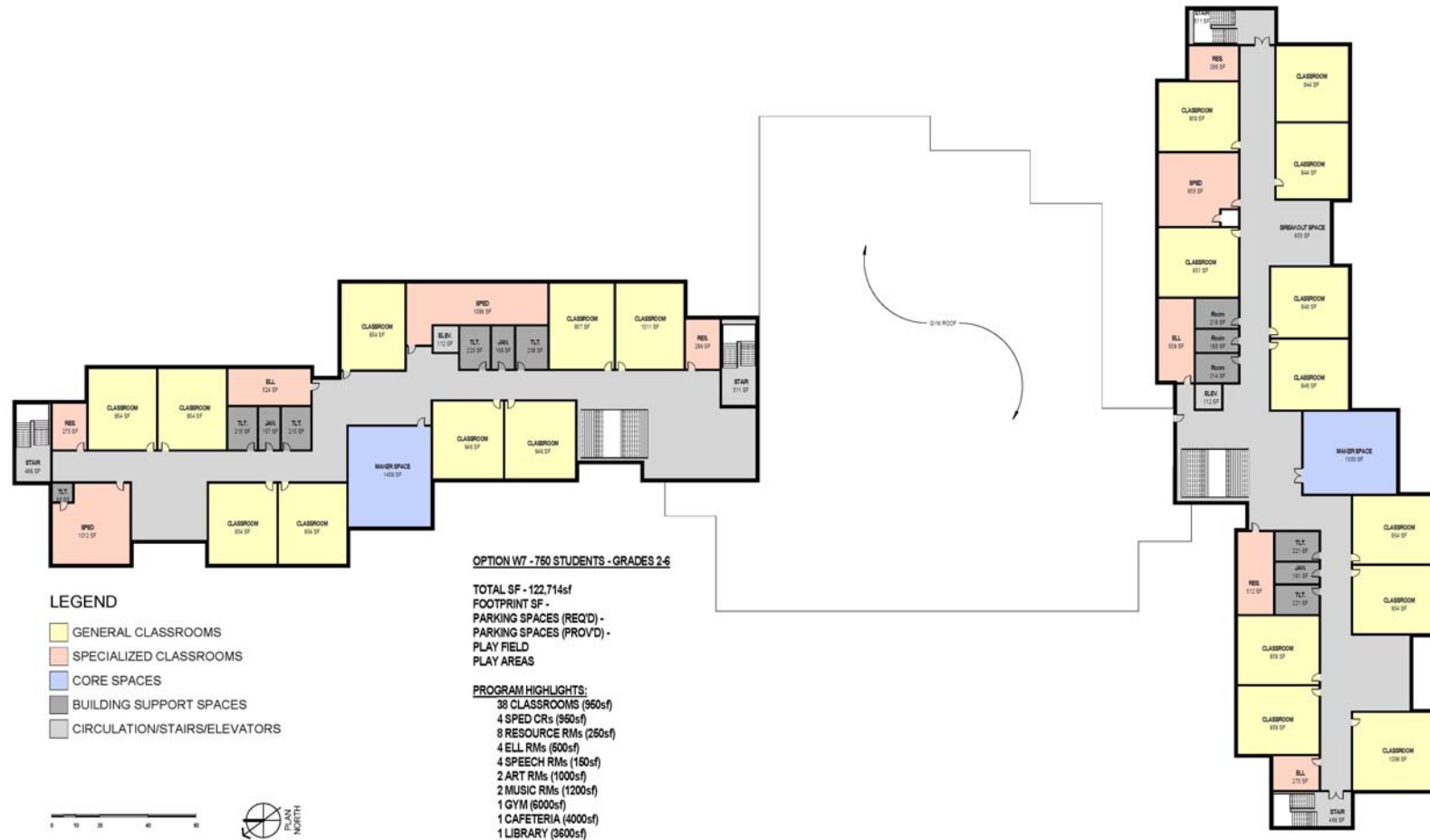

1 OPTION W7 - SECOND FLOOR PLAN
1" = 20'-0"

OPTION FR5 - NEW (750 2-6)



OPTION FR5 - FIRST FLOOR PLAN (750 2-6)



LEGEND

- GENERAL CLASSROOMS
- SPECIALIZED CLASSROOMS
- CORE SPACES
- ADMINISTRATIVE / FACULTY
- BUILDING SUPPORT SPACES
- CIRCULATION/STAIRS/ELEVATORS

0 10 20 30 40



OPTION FR5 - 760 STUDENTS - GRADES 2-6

TOTAL SF - 122,714sf
 FOOTPRINT SF - 82,343sf
 PARKING SPACES (REQ'D) -
 PARKING SPACES (PROVD) -
 PLAY FIELD
 PLAY AREAS

PROGRAM HIGHLIGHTS:

38 CLASSROOMS (960sf)
 4 SPED CRTs (960sf)
 8 RESOURCE RMs (250sf)
 4 ELL RMs (600sf)
 4 SPEECH RMs (150sf)
 2 ART RMs (1000sf)
 2 MUSIC RMs (1200sf)
 1 GYM (6000sf)
 1 CAFETERIA (4000sf)
 1 LIBRARY (3600sf)

1 FR5 - FIRST FLOOR PLAN
 1" = 20'

OPTION FR5 - SECOND FLOOR PLAN (750 2-6)



LEGEND

- GENERAL CLASSROOMS
- SPECIALIZED CLASSROOMS
- CORE SPACES
- ADMINISTRATIVE / FACULTY
- BUILDING SUPPORT SPACES
- CIRCULATION/STAIRS/ELEVATORS



OPTION FR5 - 750 STUDENTS - GRADES 2-6

TOTAL SF - 122,714sf
 FOOTPRINT SF - 82,343sf
 PARKING SPACES (REQ'D) -
 PLAYFIELD SPACES (PROV'D) -
 PLAY AREAS

PROGRAM HIGHLIGHTS:

- 38 CLASSROOMS (800sf)
- 4 SPEL CRs (800sf)
- 8 RESOURCE RMs (250sf)
- 4 ELL RMs (600sf)
- 4 SPEECH RMs (150sf)
- 2 ART RMs (1000sf)
- 2 MUSIC RMs (1200sf)
- 1 GYM (6000sf)
- 1 CAFETERIA (4000sf)
- 1 LIBRARY (3600sf)

1 OPTION W5 - SECOND FLOOR PLAN
 1" = 20'-0"

DESIGN OPTIONS – 670 STUDENTS

TWO CO-LOCATED K-6 SCHOOLS

- Option W9 - Renovation + Additions at Wildwood Site
- Option W5 –New Construction at Wildwood site
- Option FR3 –New Construction at Fort River Site

OPTION W9 - ADD/RENO (670 CO-LOCATED K-6)

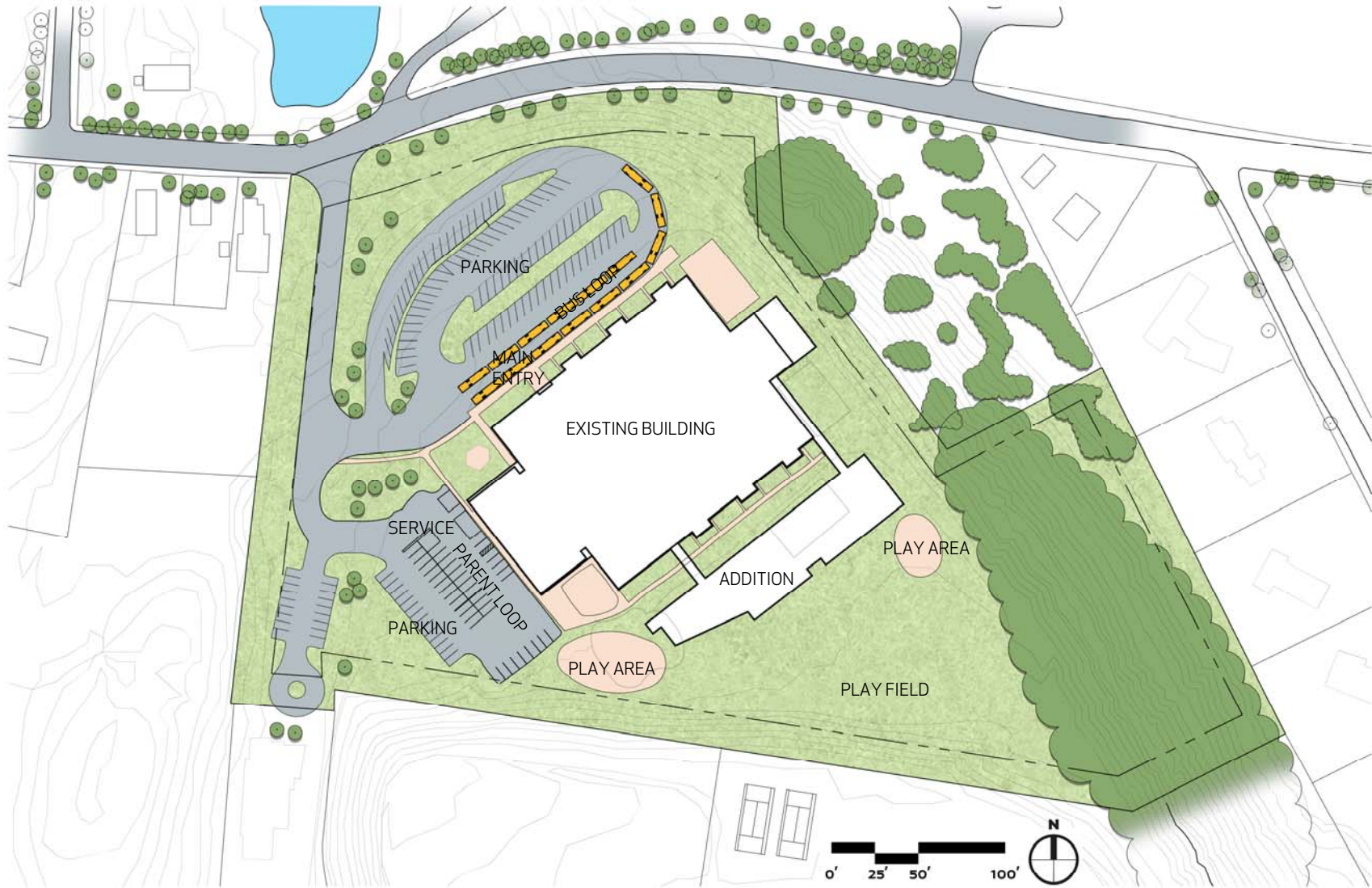

OPTION W9 - FIRST FLOOR PLAN (670 K-6)



OPTION W9 - SECOND FLOOR PLAN (670 K-6)

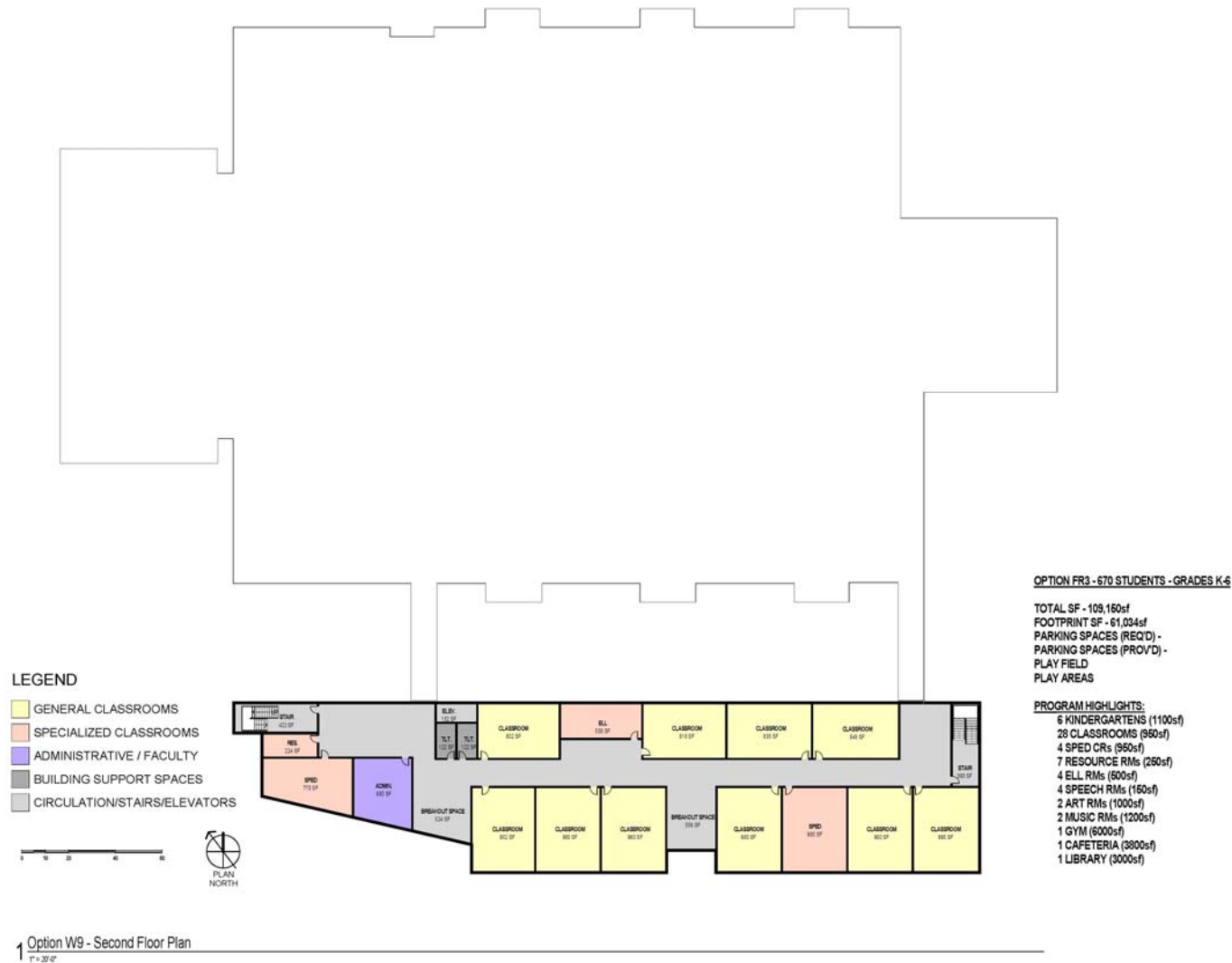

OPTION W5 - NEW (670 CO-LOCATED K-6)

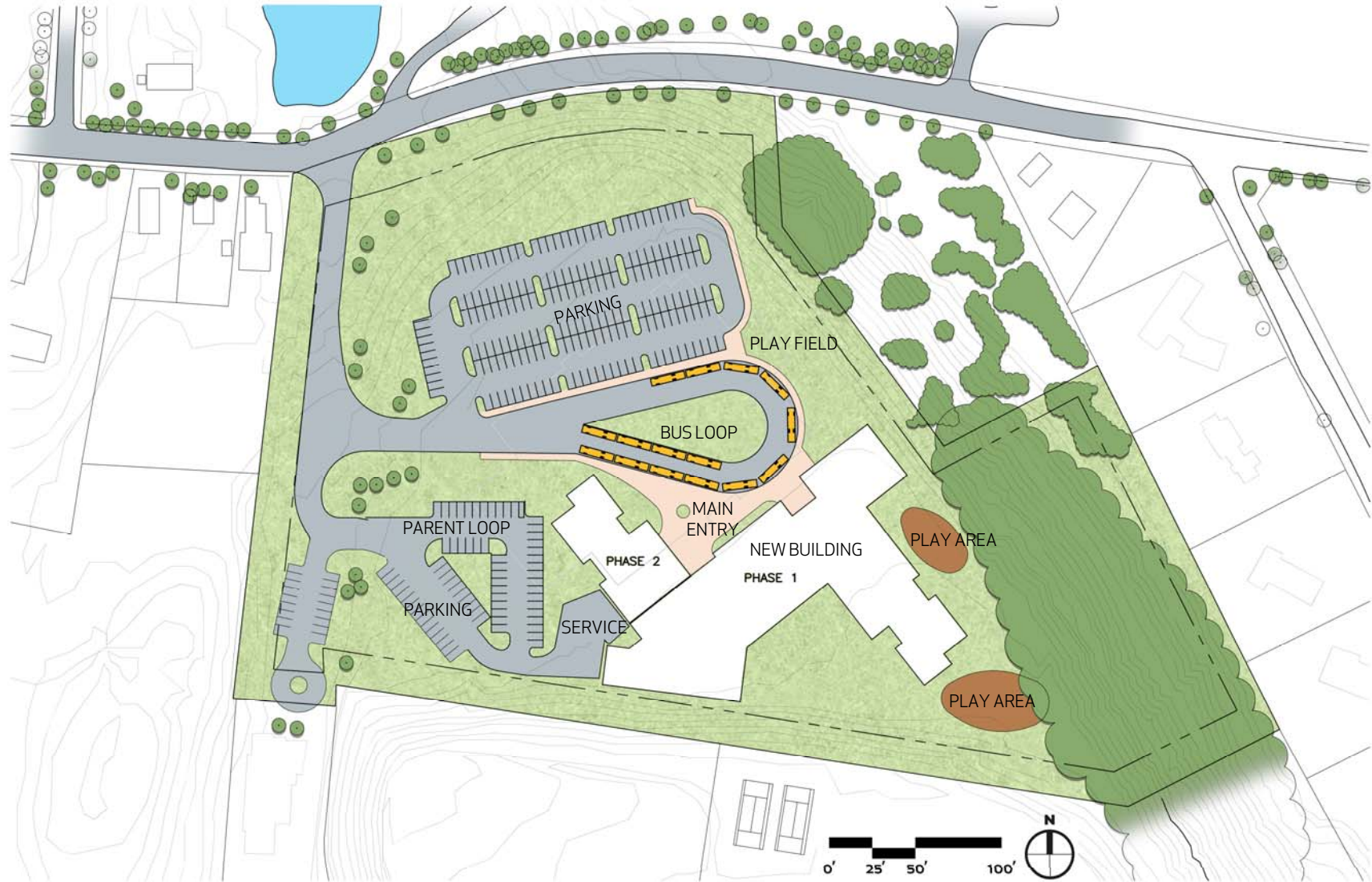

OPTION W5 - FIRST FLOOR PLAN (670 K-6)



1 OPTION 5 - FIRST FLOOR PLAN
 1"=30'-0"

OPTION W5 - SECOND FLOOR PLAN (670 K-6)



1 OPTION 5 - SECOND FLOOR PLAN
 1" = 20'-0"

OPTION FR3 - NEW (670 CO-LOCATED K-6)

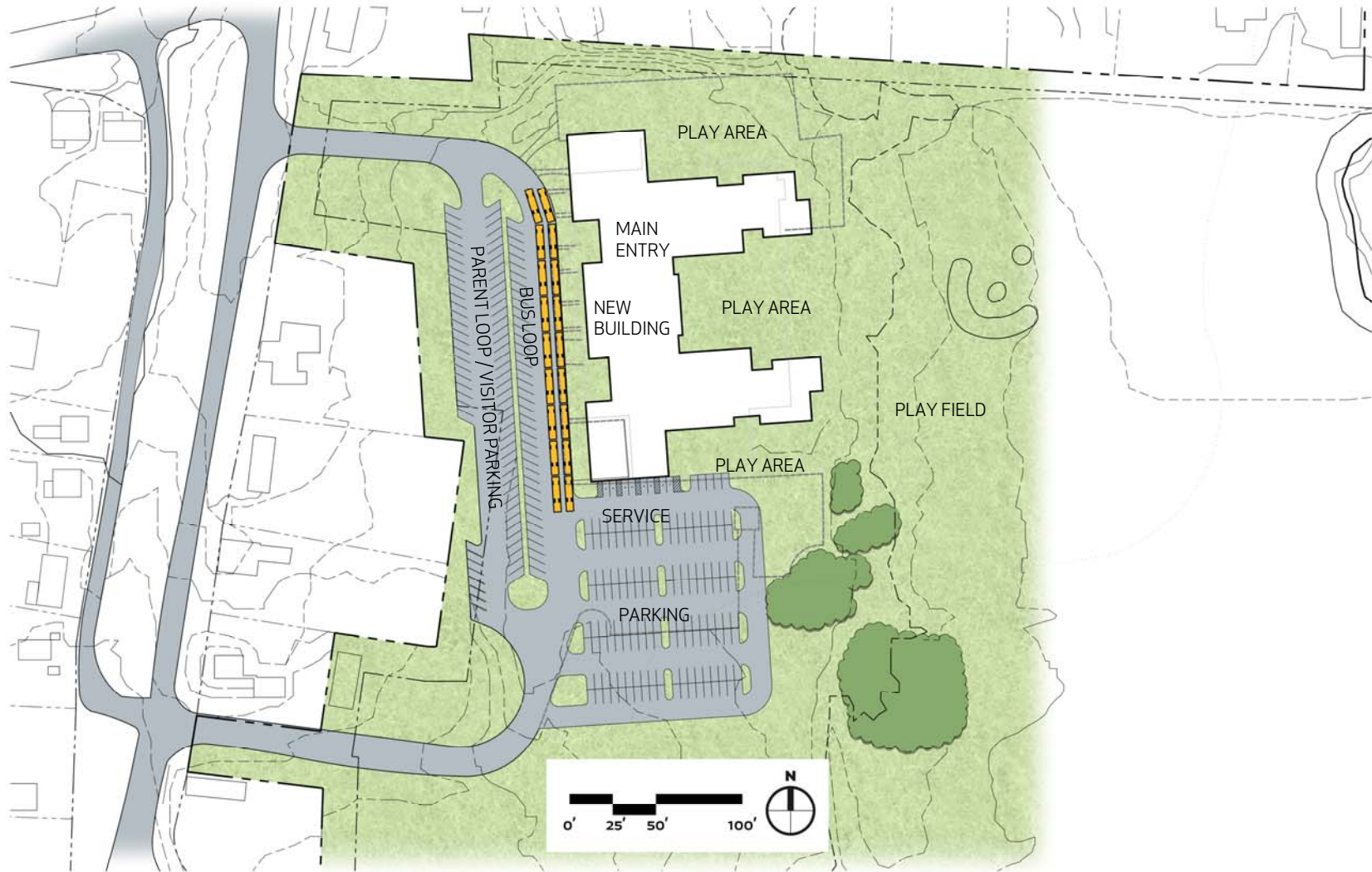

OPTION FR3 - FIRST FLOOR PLAN (670 K-6)



LEGEND

- GENERAL CLASSROOMS
- SPECIALIZED CLASSROOMS
- CORE SPACES
- ADMINISTRATIVE / FACULTY
- BUILDING SUPPORT SPACES
- CIRCULATION/STAIRS/ELEVATORS



1 OPTION FR3 - FIRST FLOOR PLAN
1" = 20'-0"

OPTION FR3 - 670 STUDENTS - GRADES K-6

TOTAL SF - 109,160sf
FOOTPRINT SF - 61,034sf
PARKING SPACES (REQ'D) -
PARKING SPACES (PROV'D) -
PLAY FIELD
PLAY AREAS

PROGRAM HIGHLIGHTS:

- 6 KINDERGARTENS (1100sf)
- 20 CLASSROOMS (950sf)
- 4 SPED CLASSES (550sf)
- 7 RESOURCE RMs (250sf)
- 4 ELL RMs (500sf)
- 4 SPEECH RMs (150sf)
- 2 ART RMs (1000sf)
- 2 MUSIC RMs (1200sf)
- 1 GYM (6000sf)
- 1 CAFETERIA (3800sf)
- 1 LIBRARY (3000sf)

OPTION FR3 - SECOND FLOOR PLAN (670 K-6)

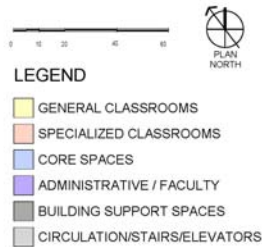

1 OPTION FR3 - SECOND FLOOR PLAN
1" = 20'-0"

OPTION FR3 - 670 STUDENTS - GRADES K-6

TOTAL SF - 109,160sf
FOOTPRINT SF - 61,034sf
PARKING SPACES (REQ'D) -
PARKING SPACES (PROVD) -
PLAY FIELD
PLAY AREAS

PROGRAM HIGHLIGHTS:

6 KINDERGARTENS (1100sf)
28 CLASSROOMS (860sf)
4 SPED CRs (960sf)
7 RESOURCE RMs (260sf)
4 ELL RMs (600sf)
4 SPEECH RMs (160sf)
2 ART RMs (1000sf)
2 MUSIC RMs (1200sf)
1 GYM (6000sf)
1 CAFETERIA (3800sf)
1 LIBRARY (3000sf)

PRELIMINARY PROJECT BUDGETS

| | Wildwood K-6 | | | Grade Reconfiguration 2-6 | | | Co-Located Schools K-6 | | |
|--|-----------------------------|------------------------------|--------------------------------|-------------------------------------|---|--|------------------------------------|--|--|
| Option (Description) | Code Updates: Existing | Option W1: Renovation K-6 | Option W2: New Construction | Option W10 Renovation + Addition | Option W7: New Construction (Swing Space) | Option FR5: New Construction (Swing Space) | Option W9 Renovation + Addition | Option W5: New Construction (Phased) | Option FR3: New Construction (Swing Space) |
| Student Enrollment | 360 | 360 | 360 | 750 | 750 | 750 | 670 | 670 | 670 |
| Total Gross Square Feet | 82,000 | 82,000 | 68,080 | 126,000 | 122,714 | 122,714 | 118,000 | 109,150 | 109,150 |
| Estimated Total Construction (cost/sf) | \$15,203,000 \$185.39/sf | \$27,729,000 \$338.15/sf | \$30,846,000 \$453.07/sf | \$48,989,000 \$388.80/sf | \$53,060,000 \$432.38/sf | \$52,605,000 \$428.68/sf | \$45,618,000 \$386.58/sf | \$47,259,000 \$432.97/sf | \$47,032,000 \$430.89/sf |
| Estimated Total Project Costs | \$19,004,000 | \$34,662,000 | \$38,558,000 | \$61,237,000 | \$66,325,000 | \$65,757,000 | \$57,023,000 | \$59,074,000 | \$58,790,000 |
| Estimated Reimbursement (50%) | \$9,502,000 | \$17,331,000 | \$19,279,000 | \$30,619,000 | \$33,163,000 | \$32,879,000 | \$28,512,000 | \$29,537,000 | \$29,395,000 |
| Estimated Cost to Amherst | \$9,502,000 | \$17,331,000 | \$19,279,000 | \$30,618,000 | \$33,162,000 | \$32,878,000 | \$28,511,000 | \$29,537,000 | \$29,395,000 |



CROCKER FARM



FORT RIVER



WILDWOOD

DISCUSSION

SCHOOL BUILDING PROJECT
COMMUNITY FORUM # 4



CROCKER FARM



FORT RIVER



WILDWOOD

NEXT STEPS

SCHOOL BUILDING PROJECT
COMMUNITY FORUM # 4

Next Steps

Provide us your feedback

- Return handouts to:
Wildwood School Building Committee
c/o Amherst Public Schools
170 Chestnut Street
Amherst, MA 01002
- Email comments to:
morrism@arps.org
- Visit us on Facebook @ Amherst Elementary School Building Project
- Visit <http://wildwood.projects.joslinlesser.com> to review project web page.
- Next Meetings:
 - School Committee Meeting, January 14, 2016 at 3:30PM
Discuss On-line Survey Results
 - School Committee Meeting, January 19, 2016 at 6:30PM
Approve Grade Configuration
 - School Building Committee Meeting, January 21, 2016 at 4:00PM
Approve Preferred Schematic Option